

## New Indo Master

# *Dragons, Mantas and more* KOMODO - INDONESIA

Special Group Departure

19 - 26 June 2025

8 days | 7 nights Ex Denpasar Bali  
from \$5,675 per Diver

### Airfares and Taxes

- Return flights from Denpasar to Labuan Bajo (fares subject to change until paid in full and ticketed based on 2024 rates)
- Includes applicable airline taxes (subject to change)

### Accommodation & Liveboard details

- Return airport transfers in Labuan Bajo
- 7 nights twin / double share accommodation aboard in classic or premium cabin "MV Indo Master" Liveboard
- All meals, tea, coffee, fruit juice & soft drinks included
- Up to 4 dives / day, including night dives (except on day of arrival and departure)
- Tanks, weights, guides and dive tenders
- Guided tour on Komodo Island

**NOTE: Upgrade to Superior Double cabin with balcony - \$395 pp**

### Price does not include

- International flights to and from Bali (see note above)
- Travel insurance, personal expenses / Ranger Fees for land excursions
- Marine Park and Port Fee USD 180 - must be paid on board (subject to change)

### Booking conditions and requirements:

To secure your place on this trip, please complete an online booking form and return it together with a deposit amount of \$500.

Package subject to change at any time without notice due to supplier rate changes and exchange rate variations. See other terms & conditions as per the Dive Adventures website [www.diveadventures.com.au](http://www.diveadventures.com.au)

Your on line booking link



One for the bucket list!



398 Harbour Drive, Coffs Harbour NSW 2450

PH: (02) 6651 1611

Email: [mail@jettydive.com.au](mailto:mail@jettydive.com.au)



IATA 02341824

# KOMODO - INDONESIA

Dragons, Mantas and more!



from \$5675\*

Special Group Departure from Denpasar  
19 - 26 June 2025



Join us on the voyage of a lifetime aboard the beautiful MY Indo Master to the remote and pristine reefs of Komodo - Indonesia.

Komodo National Park was established in 1980. Initially the main purpose of the Park was to conserve the unique Komodo Dragon and its habitat. The world's largest living lizard can grow over 3 metres and can weigh between 70-150 kilograms. Under the water, the Park has one of the richest marine environments including coral reefs, mangroves, seagrass beds, seamounts, and semi-enclosed bays.





# Komodo

Indonesia



P. Sangeang

*Flores Sea*

Gili Banta

Gili Lawa Laut

Komodo

Current City

Rinca Is.

Nusa Kode

*Savu Sea*

*Indian Ocean*



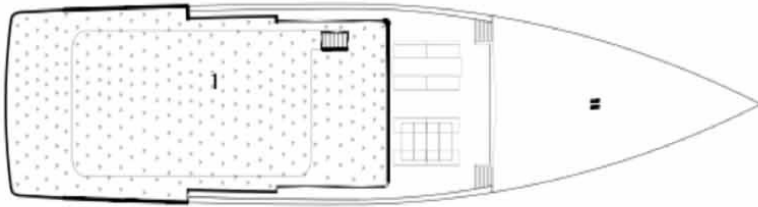

Rooftop



Upper Deck

- 1. Rooftop
- 2&3. Master Suite Double
- 4&5. Master Suite Twin
- 6. CD/TL Room
- 7. Captain Room
- 8. Bridge
- 9. BBQ Lounge

- 10. Diving Deck
- 11. Laundry Room
- 12. Bar
- 13. Kitchen
- 14. Restaurant
- 15. Indoor Lounge
- 16. Outdoor Lounge
- 17. Crew Room
- 18. Engine Room
- 19&20. Suite Double
- 21&22. Suite Twin
- 23. Family Suite



Main Deck

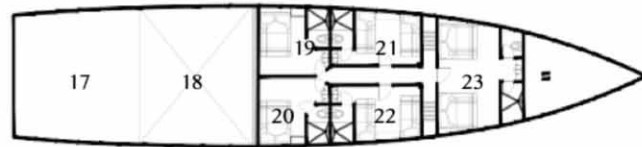

Lower Deck



INDOOR LOUNGE, RESTAURANT AND BAR

